

Sug. Loaf -  
Luzerne

W

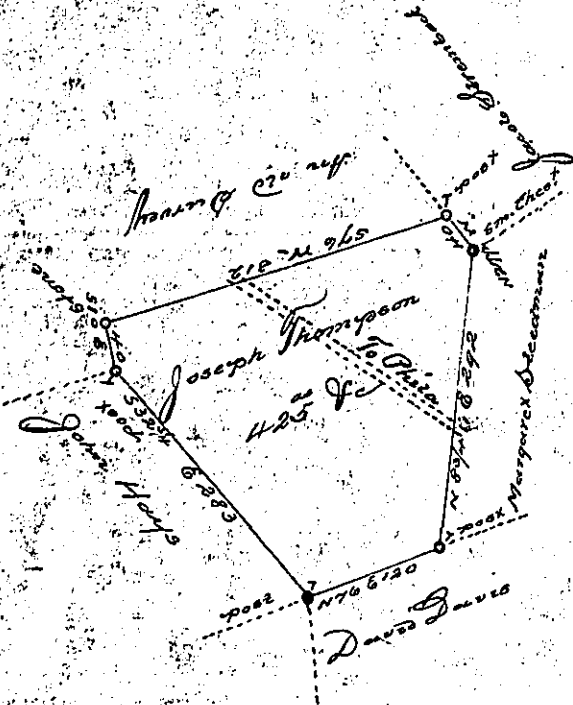

A draft of a tract of land, called *new divide on the Road from Berwick to Philadelphia*, in the County of Luzerne, containing four hundred & twenty-five acres of more or less. Surveyed for Joseph Thompson the 30<sup>th</sup> day of October, 1793, in virtue of a warrant dated the 13<sup>th</sup> day of June 1793, by  
 Wm Gray, R.S.

To  
 Daniel Brodhead Esq.  
 Dear Sir!



IN TESTIMONY that the above is a copy of the original remaining on file in the Department of Internal Affairs of Pennsylvania, made conformably to an Act of Assembly approved the 16th day of February, 1833, I have hereunto set my Hand and caused the Seal of said Department to be affixed at Harrisburg, this first day of March, 1898

James W. Latta  
 Secretary of Internal Affairs.